



AREA STATEMENT AND FLOOR PLAN



Adorn Architects & Designers
Ar. Akshay Vilas Newase (B. Arch)

ARCHITECTURE . INTERIOR . LANDSCAPE



B) ADMINISTRATIVE AREA			
SR. NO	ROOM NO	PARTICULARS	AREA (SQ.M)
41	119	PRINCIPAL CABIN	35.3
42	115	VICE PRINCIPAL CABIN	30.1
43	116	ADMINISTRATIVE AREA	91.5
44	310	NSS ROOM	20.05
45	109	STORE ROOM-1	100
46	210	STORE ROOM-2	21.1
47	121	RECORD ROOM -1	30.7
48	OO3	RECORD ROOM -2	84.13
49	111	MAINTENANCE ROOM	30.07
50	106	HOD CABIN (DIPLOMA)	10.7
51	107	STAFF ROOM	80.46
52	118	PANTRY	10.7
53	120	BOARD ROOM	55.8
54	112	HOD ROOM -1	20.02
55	211	HOD ROOM -2	21.1
56	212	HOD ROOM -3	20.05
57	105	IQAC ROOM	37.15
58	315	EXAM CONTROL OFFICE	65.12
59	316	TRAINING AND PLACEMENT CELL	31
60	G2	SECURITY CABIN	10.02
(B)	ADMINISTRATIVE AREA		805.07
C) AMENITIES AREA			
SR. NO	ROOM NO	PARTICULARS	AREA (SQ.M)
61	122	GIRLS COMMON ROOM	75.2
62	301	BOYS COMMON ROOM	77.86
63	OO2	GYMNASIUM	64.08
64	123	PH TOILET	10.7
65	217	TOILET (GIRLS)	21.67
66	218	TOILET (BOYS)	21.67
67	318	TOILET (GIRLS)	21.67
68	319	TOILET (BOYS)	21.67
69	306	STAFF TOILET	12.1
70	317	TOILET	4.62
71	108	TOILET	6.2
72	117	TOILET	8.1
73	216	FIRST AID CUM SICK ROOM	11.4
74	G3	CANTEEN	153
75	G4	STAFF PARKING	200
76	G5	STUDENT PARKING	450
77	G6	AMPHITHEATOR	640
(C)	AMINITIES AREA		799.94
(D)	CIRCULATION AREA		777.46
(E)	TOTAL		7061.98

(Signature)
AKSHAY V. NEWASE
Regd. Architect
CA/2018/97103

E-MAIL : ADORNARCHSTUDIO@GMAIL.COM CONTACT NO : +91 9607 281000

B/116 SHIVSAHNKAR APPARTMENT .SHIVTITHA NAGAR KHOTHRUD PUNE -411038



Adorn Architects & Designers

Ar. Akshay Vilas Newase (B. Arch)

ARCHITECTURE . INTERIOR . LANDSCAPE



B) ADMINISTRATIVE AREA			
SR. NO	ROOM NO	PARTICULARS	AREA (SQ.M)
41	119	PRINCIPAL CABIN	35.3
42	115	VICE PRINCIPAL CABIN	30.1
43	116	ADMINISTRATIVE AREA	91.5
44	310	NSS ROOM	20.05
45	109	STORE ROOM-1	100
46	210	STORE ROOM-2	21.1
47	121	RECORD ROOM -1	30.7
48	003	RECORD ROOM -2	84.13
49	111	MAINTENANCE ROOM	30.07
50	106	HOD CABIN (DIPLOMA)	10.7
51	107	STAFF ROOM	80.46
52	118	PANTRY	10.7
53	120	BOARD ROOM	55.8
54	112	HOD ROOM -1	20.02
55	211	HOD ROOM -2	21.1
56	212	HOD ROOM -3	20.05
57	105	IQAC ROOM	37.15
58	315	EXAM CONTROL OFFICE	65.12
59	316	TRAINING AND PLACEMENT CELL	31
60	G2	SECURITY CABIN	10.02

(B)	ADMINISTRATIVE AREA	805.07
-----	---------------------	--------

C) AMENITIES AREA			
SR. NO	ROOM NO	PARTICULARS	AREA (SQ.M)
61	122	GIRLS COMMON ROOM	75.2
62	301	BOYS COMMON ROOM	77.86
63	002	GYMNASIUM	64.08
64	123	PH. TOILET	10.7
65	217	TOILET (GIRLS)	21.67
66	218	TOILET (BOYS)	21.67
67	318	TOILET (GIRLS)	21.67
68	319	TOILET (BOYS)	21.67
69	306	STAFF TOILET	12.1
70	317	TOILET	4.62
71	108	TOILET	6.2
72	117	TOILET	8.1
73	216	FIRST AID CUM SICK ROOM	11.4
74	G3	CANTEEN	153
75	G4	STAFF PARKING	200
76	G5	STUDENT PARKING	450
77	G6	AMPHITHEATOR	640
(C)	AMINITIES AREA		799.94
(D)	CIRCULATION AREA		777.46
(E)	TOTAL		7061.98

Akshay Vilas Newase
AKSHAY VILAS NEWASE
 Regd. Architect
 CA/2018/97103

E-MAIL : ADORNARCHSTUDIO@GMAIL.COM

CONTACT NO : +91 9607 281000

B/116 SHIVSAHNKAR APPARTMENT .SHIVTITHA NAGAR KHOTHRUD PUNE -411038

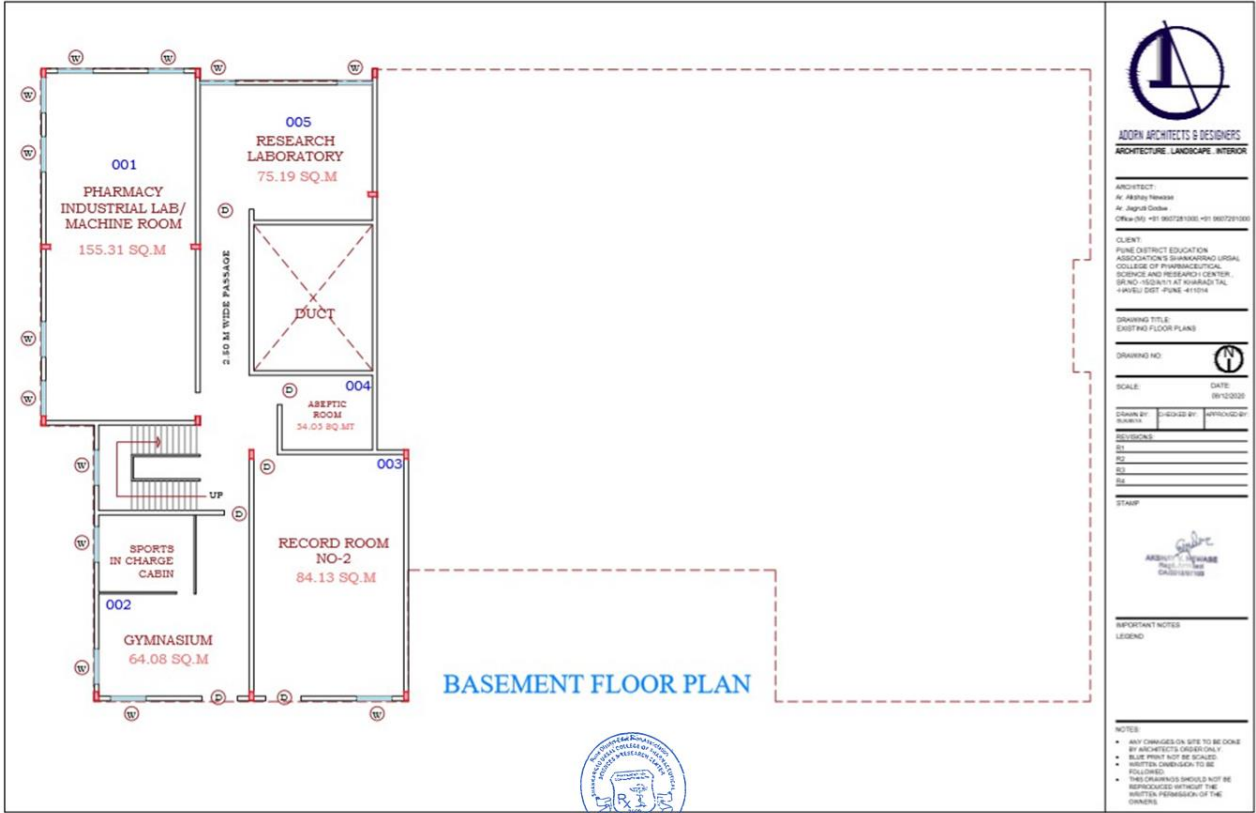

AADPA ARCHITECTS & DESIGNERS
ARCHITECTURE, LANDSCAPE, INTERIOR

ARCHITECT
A/ Arjun Tewari
A/ Ajay Gade
CIN-09 / +91 9872103611 +91 9872103611

CLIENT
PUNE DISTRICT EDUCATION
ASSOCIATION'S SHANKARAO URJAL
COLLEGE OF PHARMACEUTICAL
SCIENCE AND RESEARCH CENTER,
SRINO. HOSUR AT SHANKAR TAL,
+MULLU DIST -PUNE -411014

DRAWING TITLE
EXISTING FLOOR PLANS

DRAWING NO.

SCALE: DATE: 06/10/2020

DRAWN BY: DESIGNED BY: APPROVED BY:

REVISIONS
S1
S2
S3

STAFF



IMPORTANT NOTES
LEGEND

- NOTES
- ANY CHANGES ON SITE TO BE DONE BY ARCHITECT'S ORDER ONLY
 - BLUE PRINT NOT BE SCALED
 - WRITTEN DIMENSIONS TO BE FOLLOWED
 - THIS DRAWING SHOULD NOT BE REPRODUCED WITHOUT THE WRITTEN PERMISSION OF THE DRAWER

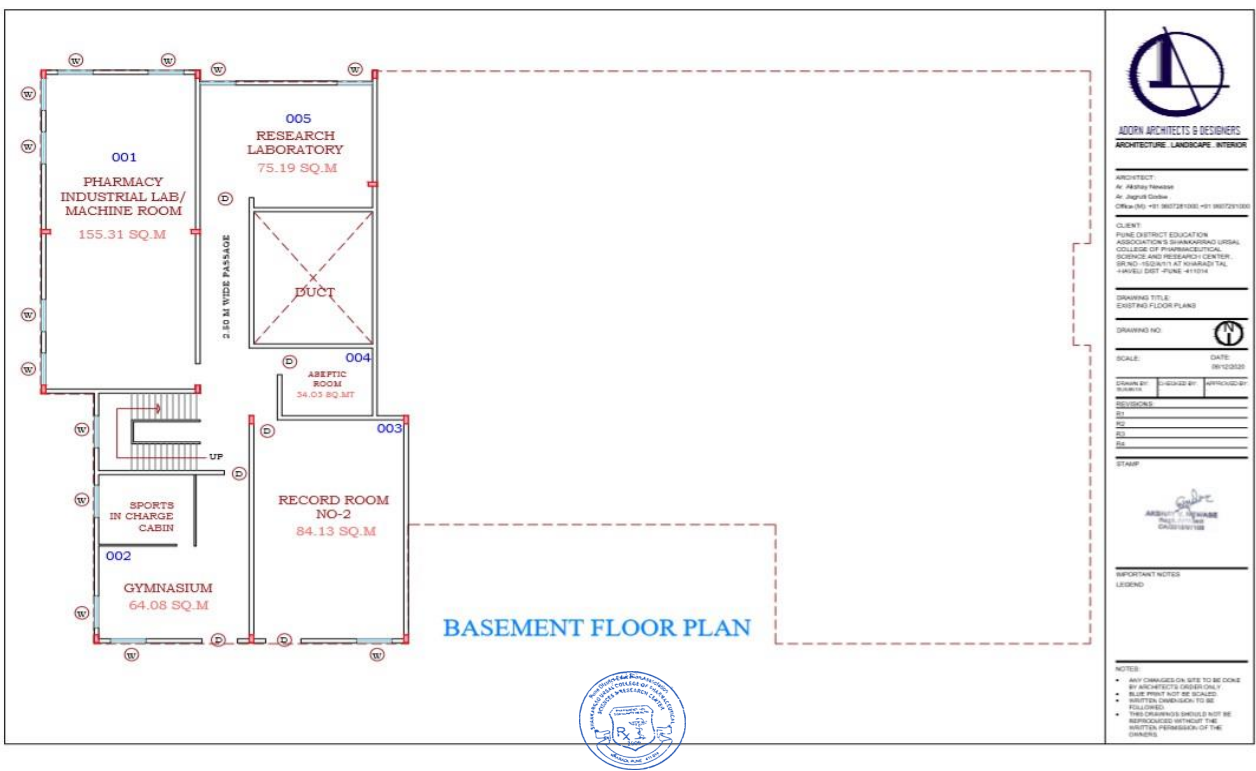

AADPA ARCHITECTS & DESIGNERS
ARCHITECTURE, LANDSCAPE, INTERIOR

ARCHITECT
A/ Arjun Tewari
A/ Ajay Gade
CIN-09 / +91 9872103611 +91 9872103611

CLIENT
PUNE DISTRICT EDUCATION
ASSOCIATION'S SHANKARAO URJAL
COLLEGE OF PHARMACEUTICAL
SCIENCE AND RESEARCH CENTER,
SRINO. HOSUR AT SHANKAR TAL,
+MULLU DIST -PUNE -411014

DRAWING TITLE
EXISTING FLOOR PLANS

DRAWING NO.

SCALE: DATE: 06/10/2020

DRAWN BY: DESIGNED BY: APPROVED BY:

REVISIONS
S1
S2
S3

STAFF



IMPORTANT NOTES
LEGEND

- NOTES
- ANY CHANGES ON SITE TO BE DONE BY ARCHITECT'S ORDER ONLY
 - BLUE PRINT NOT BE SCALED
 - WRITTEN DIMENSIONS TO BE FOLLOWED
 - THIS DRAWING SHOULD NOT BE REPRODUCED WITHOUT THE WRITTEN PERMISSION OF THE DRAWER

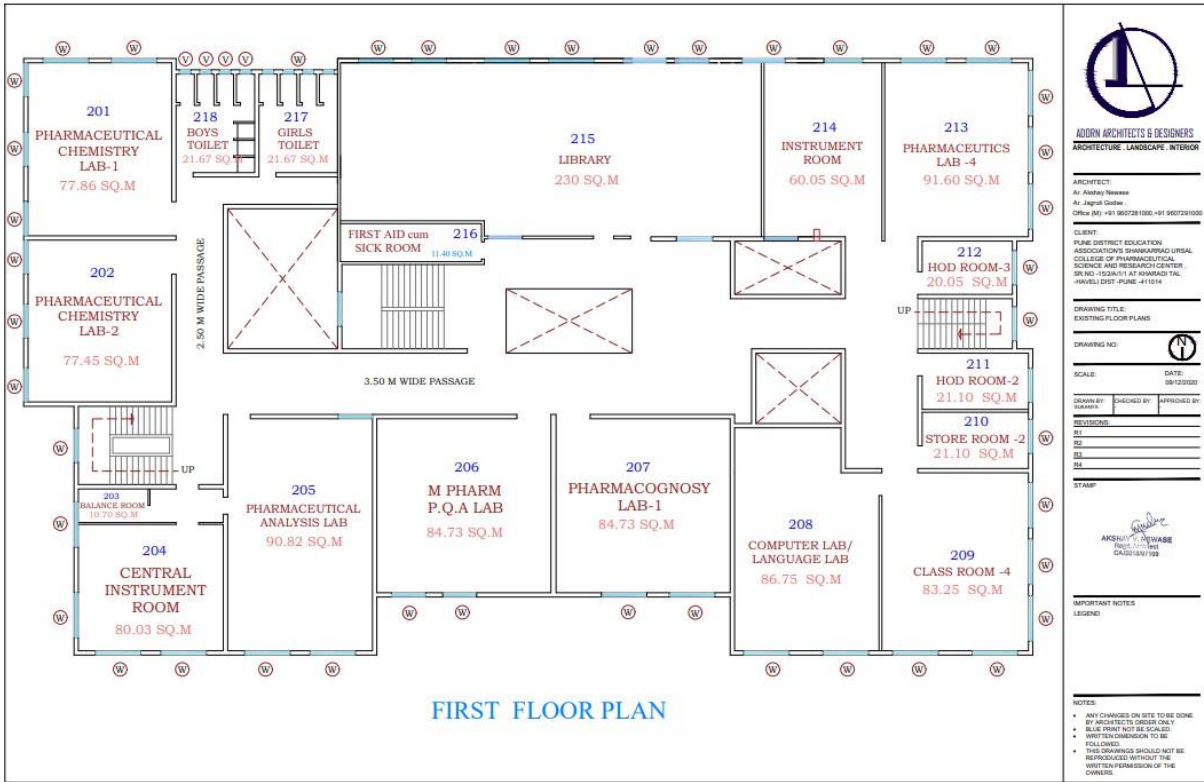
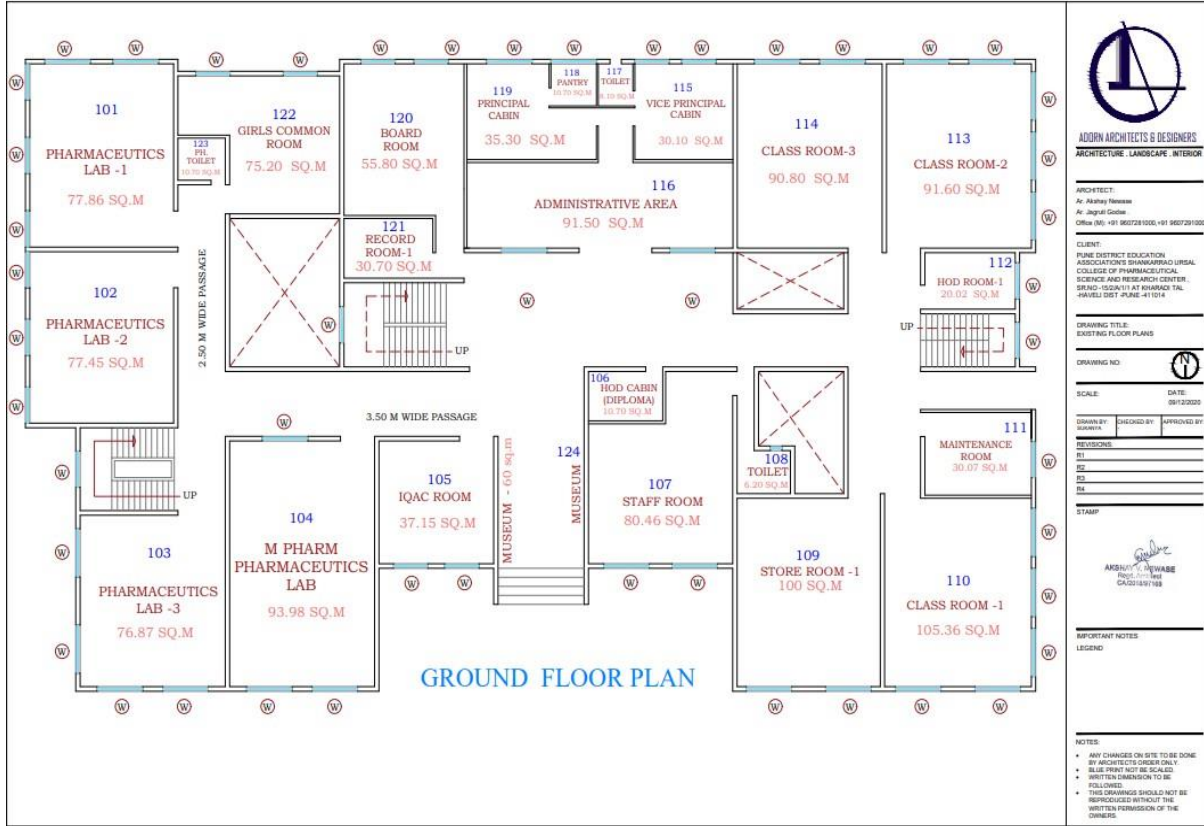

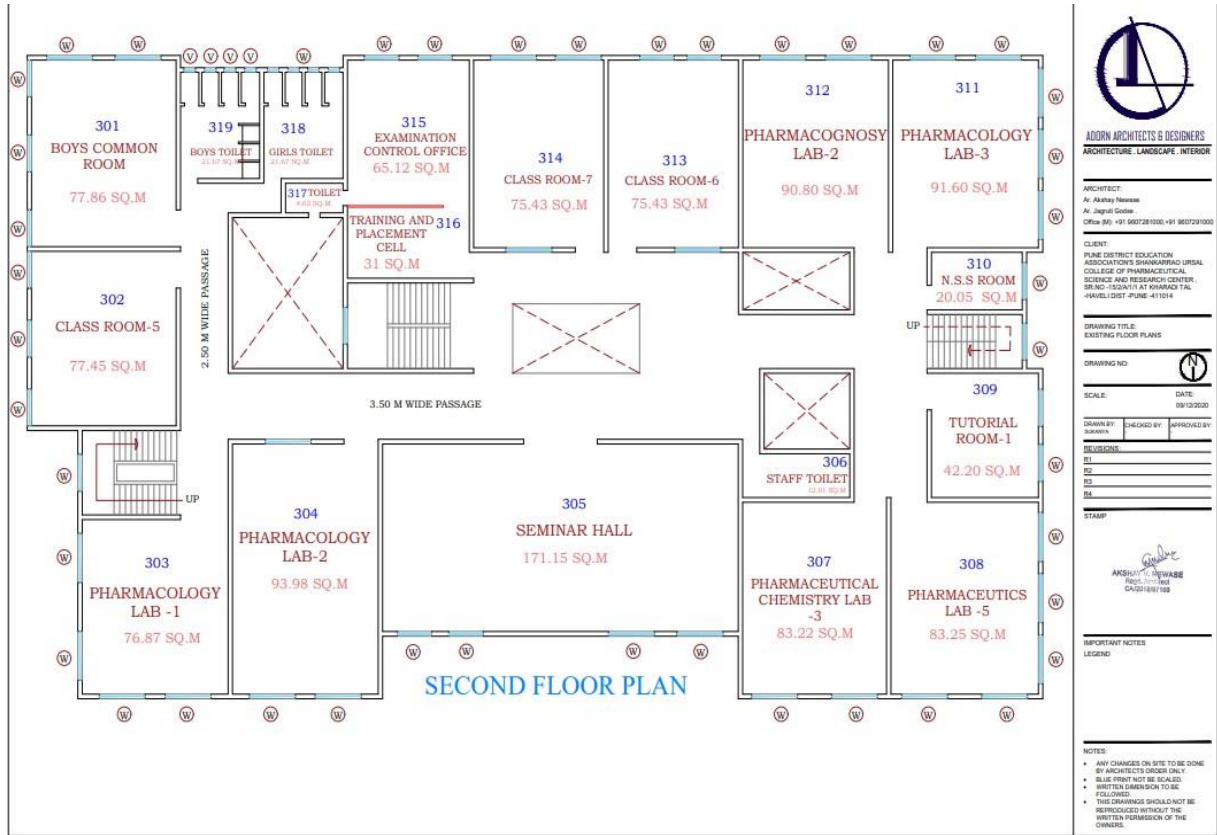



AAD ARCHITECTS & DESIGNERS
ARCHITECTURE, LANDSCAPE, INTERIOR

ARCHITECT:
A. Akshay Nimesh
A. Jyoti Gode
Office (M) : +91 9807281000, +91 9807291000

CLIENT:
PUNE DISTRICT EDUCATION ASSOCIATION'S SHANKARRAO URDAL COLLEGE OF PHARMACEUTICAL SCIENCE AND RESEARCH CENTER, SRINAGAR ROAD AT KAWADI TAL. -HAVELI DIST -PUNE -411014

DRAWING TITLE:
EXISTING FLOOR PLANS

DRAWING NO.:

SCALE: DATE: 09/12/2020

DRAWN BY: CHECKED BY: APPROVED BY:

REVISIONS:

R1

R2

R3

R4

STAMP



AKSHAY NIMESH
 Reg. No. CA201819188

IMPORTANT NOTES

LEGEND

NOTES:

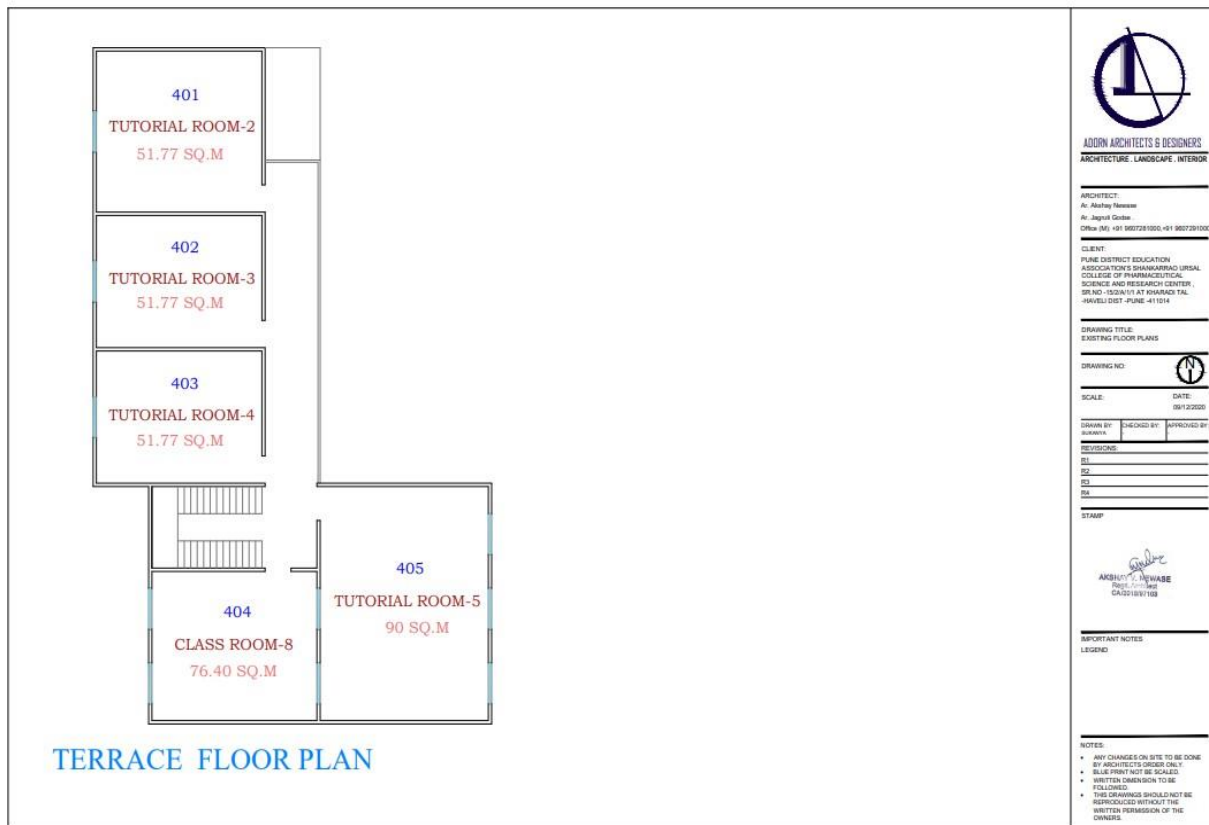
- ANY CHANGES ON SITE TO BE DONE BY ARCHITECTS ORDER ONLY
- BLUE PRINT NOT BE SCALED
- WRITTEN DIMENSION TO BE FOLLOWED
- THE DRAWINGS SHOULD NOT BE REPRODUCED WITHOUT THE WRITTEN PERMISSION OF THE OWNERS





AAD ARCHITECTS & DESIGNERS
ARCHITECTURE, LANDSCAPE, INTERIOR

ARCHITECT:
A. Akshay Nimesh
A. Jyoti Gode
Office (M) : +91 9807281000, +91 9807291000

CLIENT:
PUNE DISTRICT EDUCATION ASSOCIATION'S SHANKARRAO URDAL COLLEGE OF PHARMACEUTICAL SCIENCE AND RESEARCH CENTER, SRINAGAR ROAD AT KAWADI TAL. -HAVELI DIST -PUNE -411014

DRAWING TITLE:
EXISTING FLOOR PLANS

DRAWING NO.:

SCALE: DATE: 09/12/2020

DRAWN BY: CHECKED BY: APPROVED BY:

REVISIONS:

R1

R2

R3

R4

STAMP

AKSHAY NIMESH
 Reg. No. CA201819188

IMPORTANT NOTES

LEGEND

NOTES:

- ANY CHANGES ON SITE TO BE DONE BY ARCHITECTS ORDER ONLY
- BLUE PRINT NOT BE SCALED
- WRITTEN DIMENSION TO BE FOLLOWED
- THE DRAWINGS SHOULD NOT BE REPRODUCED WITHOUT THE WRITTEN PERMISSION OF THE OWNERS